

1
2
3
4
5
6
7
8
9
10
11
12
13
14
15
16
17
18
19
20
21
22
23
24
25
26
27
28

IN THE SUPERIOR COURT OF THE STATE OF ARIZONA
IN AND FOR THE COUNTY OF MARICOPA

IN RE THE GENERAL
ADJUDICATION OF ALL RIGHTS
TO USE WATER IN THE GILA
RIVER SYSTEM AND SOURCE

W1-00-001234 (Consolidated)

Contested Case No. **W1-11-003375**

**ORDER INITIATING CONTESTED
CASE**

CONTESTED CASE NAME: *In re ASLD – D.B. Sanford*
HSR INVOLVED: San Pedro Hydrographic Survey.
DESCRIPTIVE SUMMARY: The Clerk of the Maricopa County Superior Court is directed to initiate W1-11-3375. Arizona State Land Department shall file with the Special Master a statement declaring the claims that it intends to pursue by **May 22, 2026**, and draft abstracts by **June 22, 2026**.
NUMBER OF PAGES: 8

This order opens a case to determine rights to use water on land owned by the Arizona State Land Department ("ASLD").

In this case, ASLD filed statement of claimant ("SOC") 39-13169. The Arizona Department of Water Resources ("ADWR") investigated the claims and prepared watershed file report ("WFR") 115-05-056, published in the San Pedro River Hydrographic Survey Report ("HSR"). A copy of the WFR is attached as Attachment A. A map illustrating the area investigated in the WFR is attached as Attachment B. The

1 WFR describes stock watering in SE¼SW¼NE¼ Section 1 Township 7S, Range 19E.

2 **WFR 115-05-056** lists the Arizona State Land Department ("ASLD") as the owner
3 of the land investigated. ASLD records indicate that the property investigated currently
4 comprises **ASLD parcel 023-102853-05**. A map depicting the parcel is attached as
5 Attachment C. The public records of ADWR do not contain any assignments of the SOC
6 listed in the WFR. Further, neither the state nor lessees appear to have filed any additional
7 SOC's since the issuance of the HSR.

8 Objections were timely filed to the findings made in the WFR by ASLD, the Gila
9 River Indian Community, San Carlos Apache Tribe, Tonto Apache Tribe, and the
10 Yavapai-Apache Nation.

11 **IT IS ORDERED:**

12 **1. Case Initiation.** This order initiates contested case W1-11-003375.

13 **2. Declaration.** By **May 22, 2026**, ASLD shall review all SOC's relevant to this
14 contested case, file with ADWR all amendments or additional claims that it intends
15 to pursue, and declare all such claims to the Court.

16 **3. Draft Abstracts.** By **June 22, 2026**, ASLD shall file draft abstracts for claims
17 eligible for summary adjudication. The parties shall file any comments to the draft
18 abstracts by **June 29, 2026**.

19 **4. Parties.** The litigants in this contested case include the current claimant and
20 landowner, lessees, and all parties who filed objections to the watershed file report.
21 The objectors are ASLD, the Gila River Indian Community, San Carlos Apache
22 Tribe, Tonto Apache Tribe, and the Yavapai-Apache Nation.

23 **5. Objections.** Copies of objections filed to this case can be found under the
24 respective case names and numbers on the following website:
25 <http://www.superiorcourt.maricopa.gov/SuperiorCourt/GeneralStreamAdjudicati>
26 [on/whatsNew.asp](http://www.superiorcourt.maricopa.gov/SuperiorCourt/GeneralStreamAdjudication/whatsNew.asp).

27 **6. Court Approved Mailing List.**

28 **A.** The initial Court Approved Mailing List for this case shall include all persons

1 listed on Attachment D to this order. The list may be modified only by filing a
2 motion with the Special Master. Litigants are responsible for using the current
3 Court Approved Mailing List.

4 **B.** A copy of any pleading filed with the Clerk of the Maricopa County Superior
5 Court in this case shall be served upon each person listed on the Court
6 Approved Mailing List.

7 **C.** Claimants wishing to be added or removed from the mailing list shall file a
8 motion with the Special Master. Parties allowed to intervene will be
9 automatically added to the Court Approved Mailing List.

10 **D.** The Clerk of the Court will send copies of all minute entries and orders issued
11 in this case to the parties listed on the Court Approved Mailing List.

12 **E.** Claimants who would like to receive courtesy copies of minute entries and
13 orders may request inclusion on an email list by sending a request to
14 emily.natale@jbazmc.maricopa.gov.

15 Signed this 9th day of April 2026.

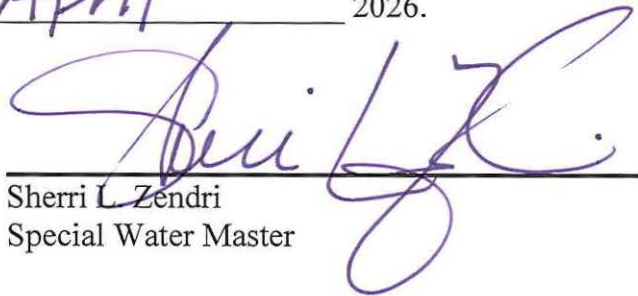
16
17
18
19
20
21

Sherri L. Zendri
Special Water Master

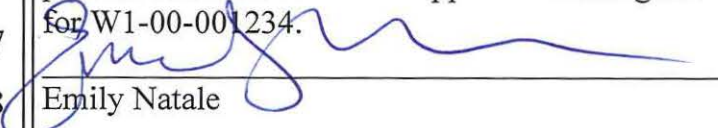
22 On April 9, 2026, the original of
23 the foregoing was delivered to the Clerk of the
24 Maricopa County Superior Court for filing and
25 distributing a copy to all persons listed on the
26 Court-approved mailing list for this contested
27 case, a copy of which is attached, and to all
28 persons listed on the Court-approved mailing list
for W1-00-001234.

Emily Natale

1
2
3
4
5
6
7
8
9
10
11
12
13
14
15
16
17
18
19
20
21
22
23
24
25
26
27
28

ATTACHMENT A
Watershed File Report

AS OF 10/11/91

LAND OWNER	WATERSHED FILE REPORT NUMBER	LESSEE/ALLOTTEE	LEASE-PERMIT ID
SLD	115-05-056	SANFORD, D.B.	05-81772

PHOTO ID - 30-10 (90) QUAD 1 - KLONDYKE

APPLICABLE FILINGS AND DECREES

CLEARLY STATED INFORMATION FROM FILINGS AND DECREES

FILING NUMBER	FILING STATUS	USES	QUANTITY IN AFA	USE LOCATION SECTION	TWNP	RNGE	CLAIM DATE	DIVERSION LOCATION SECTION	TWNP	RNGE
36-0005420		STOCK REC/FISH/WLDF	.02	SWNE01	070S	190E	< 1884	SWNE01	070S	190E
39-0013169		STOCK REC/FISH/WLDF	.02	SWNE01	070S	190E	< 1884	SWNE01	070S	190E

DWR ANALYSIS OF FILINGS AND DECREES

FILING NUMBER	USES CLAIMED OR REFERENCED	USES FOUND BY DWR	APPLIES TO DIVERSIONS	APPLIES TO PWR NUMBERS
36-0005420	STOCK WILDLIFE	STOCK INCIDENTAL		SW001
39-0013169	STOCK WILDLIFE	STOCK INCIDENTAL		SW001

USES

PWR #	LOCATION SECTION	TWNP	RNGE	SUPPLIED BY DIVERSIONS	WATER SOURCES	PHOTO SOURCE DATE	SOURCE CHANGE	FACILITY NAME
SW001	SESWNE01	070S	190E		SURFACE WATER		NO	INSTREAM USE

PWR SUMMARY

PWR #	APPLICABLE ADJ FILINGS	APPLICABLE PRE FILINGS	*APPARENT FIRST USE DATE*	DATE BASIS FOR DATE	WATER SOURCES AND CLASSIFICATIONS
SW001	39-0013169	36-0005420	1884 FILING	36-5420	SURFACE WATER: ARAVAIPA CREEK

QUANTITIES OF USE

PWR #	QUANTIFICATION TYPE	ACRES	CROP TYPE	EFF	WATER DUTY	ESTIMATED VOLUME	REMARKS
SW001							SEE VOLUME 1 - GENERAL ASSESSMENT

EXPLANATION

USES AND RESERVOIRS

SW1 - INSTREAM STOCKWATERING AND WILDLIFE USES FROM ARAVAIPA CREEK.

ATTACHMENT B

Map Illustrating Area Investigated in WFR

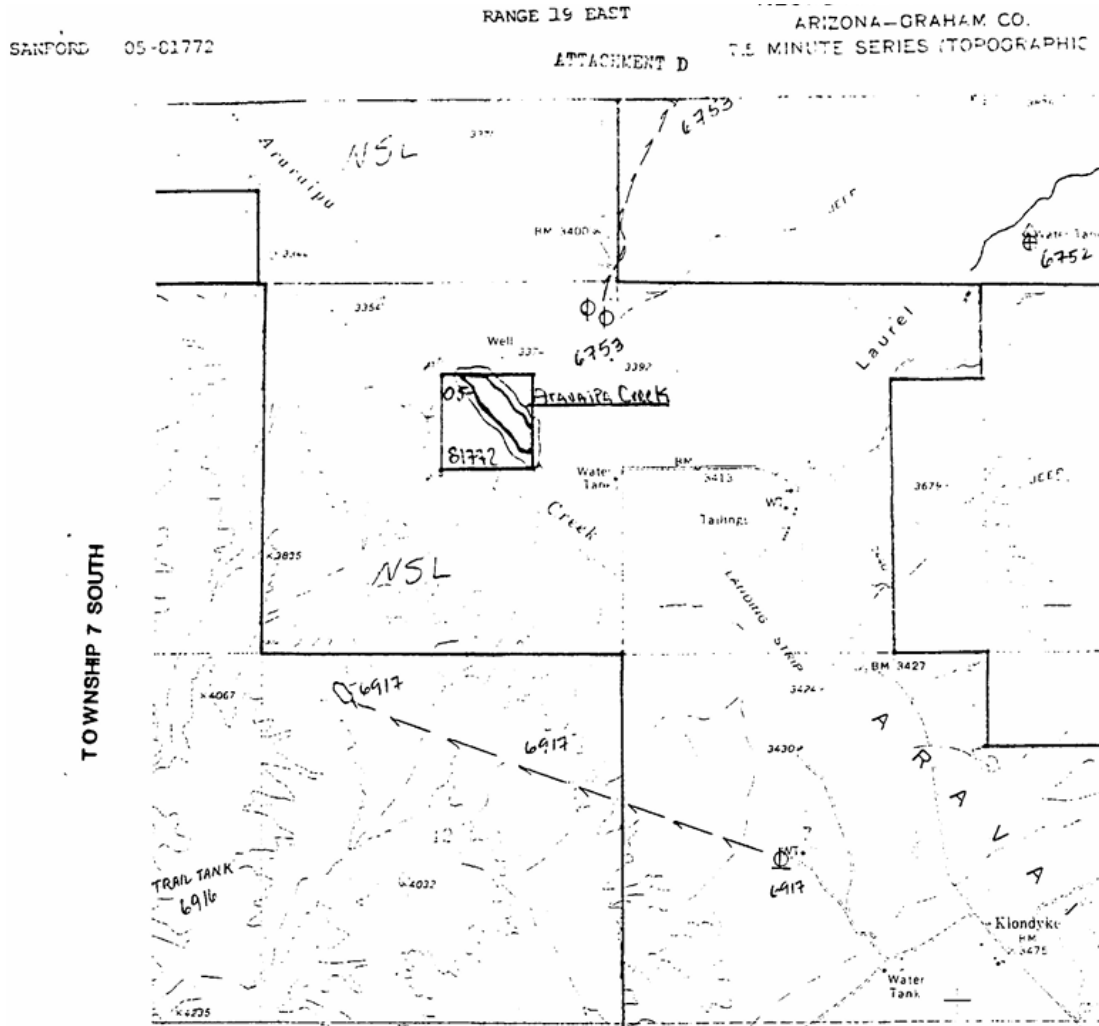

1
2
3
4
5
6
7
8
9
10
11
12
13
14
15
16
17
18
19
20
21
22
23
24
25
26
27
28

ATTACHMENT C

Parcel Map

1
2
3
4
5
6
7
8
9
10
11
12
13
14
15
16
17
18
19
20
21
22
23
24
25
26
27
28

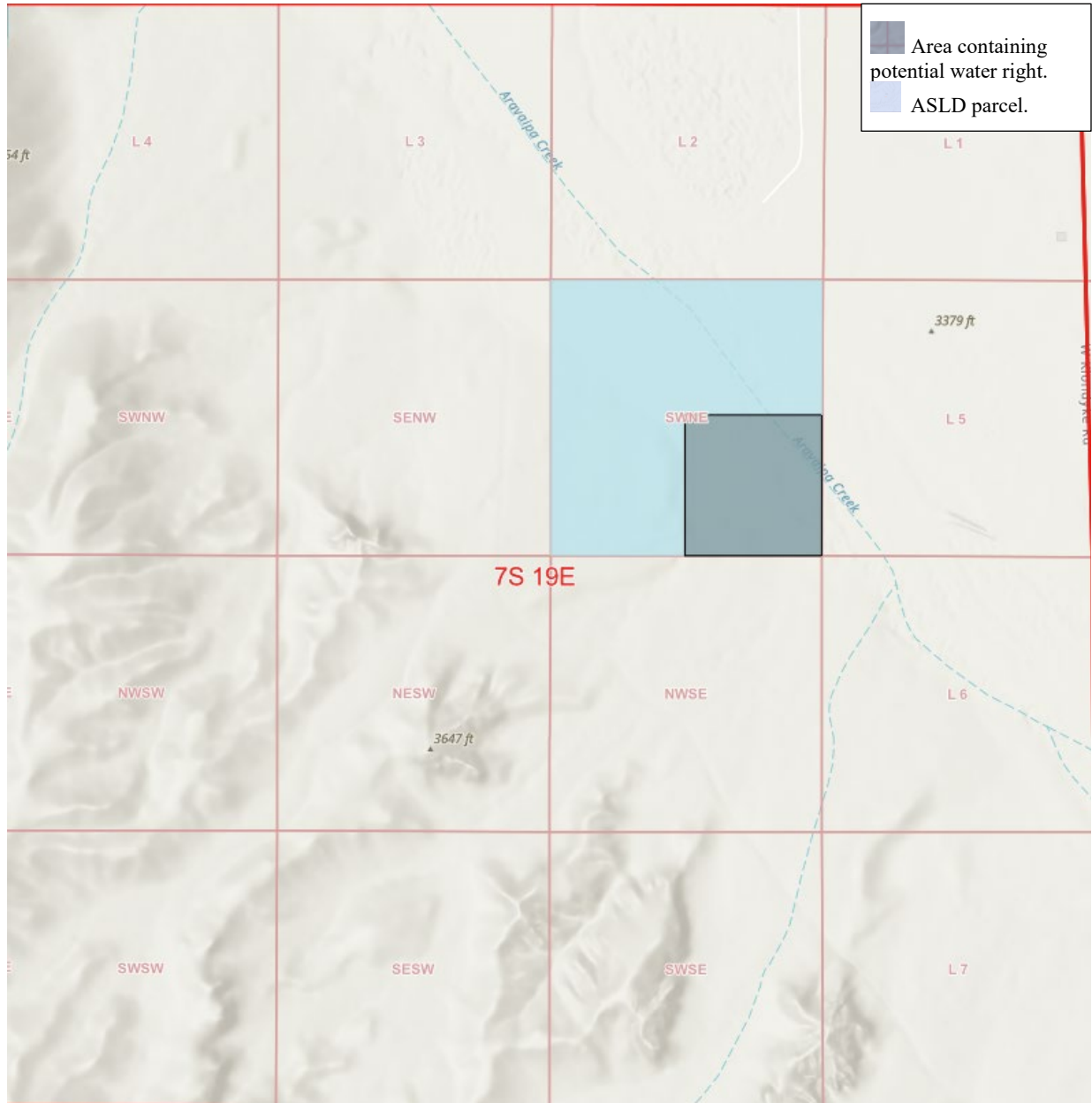

ATTACHMENT D

Initial Court-Approved Mailing List

1
2
3
4
5
6
7
8
9
10
11
12
13
14
15
16
17
18
19
20
21
22
23
24
25
26
27
28

Arizona Department of Water Resources
Karen J. Nielsen
1110 West Washington, Suite 310
Phoenix, AZ 85007

Joe P. Sparks and Laurel A. Hermann
The Sparks Law Firm, P.C.
7503 First Street
Scottsdale, AZ 85251-4573

Clerk of the Superior Court
Maricopa County
Attn: Water Case
601 West Jackson St.
Phoenix, AZ 85003

Jeremiah Weiner, Brett J. Stavin,
Rosemary Avila
Rosette, LLP.
120 S. Ash Avenue, Suite 201
Tempe, AZ 85281

Special Master Sherri Zendri
Superior Court of Arizona
201 W. Jefferson Street
Courtroom 301
Phoenix, AZ 85003

Susan B. Montgomery, Robyn Interpreter,
Montgomery & Interpreter PLC
3301 E Thunderbird Road
Phoenix, AZ 85032

David Jacobs, Kevin Crestin, &
Eric Wilkins
Arizona Attorney General Natural
Resources Section
2005 North Central Phoenix, AZ 85004

Gila River Indian Community
Javier Ramos and Michael Carter
Office of the General Counsel
P.O. Box 97
Sacaton, AZ 85147

A. Ritchie, J. Sutton, B. Velasco
San Carlos Apache Tribe
Office of the Attorney General
PO Box 40
San Carlos, AZ 85550

Merrill C. Godfrey and Brette A. Pena
Akin Gump Straus Hauer & Feld LLP
2001 K Street, N.W.
Washington, DC 20006