

1
2
3
4
5
6
7
8
9
10
11
12
13
14
15
16
17
18
19
20
21
22
23
24
25
26
27
28

**ARIZONA GENERAL STREAM ADJUDICATION
IN THE SUPERIOR COURT OF THE STATE OF ARIZONA
IN AND FOR THE COUNTY OF APACHE**

IN RE THE GENERAL
ADJUDICATION OF ALL RIGHTS
TO USE WATER IN THE LITTLE
COLORADO RIVER SYSTEM AND
SOURCE

CV6417

Contested Case No. **CV 6417-33-5711**

**ORDER INITIATING CONTESTED
CASE AND SCHEDULING INITIAL
CONFERENCE HEARING**

CONTESTED CASE NAME: *In re Melvin G. and Ruth A. Riddlebarger*
HSR INVOLVED: Silver Creek Hydrographic Survey.
DESCRIPTIVE SUMMARY: The Clerk of the Apache County Superior Court is directed to initiate CV 6417-33-5711. Parties who wish to pursue this case are ordered to attend an initial conference hearing scheduled for **June 11, 2026, at 10:30 am.**
NUMBER OF PAGES: 10

This order opens a case to determine legal rights to use water.
This case is NOT being initiated because of improper water use.

Failure of landowners to participate may result in forfeiture of water rights.

The Little Colorado River Basin is currently undergoing a general stream adjudication to determine water rights and to create an accurate, enforceable record of those rights. The general stream adjudication is currently evaluating **Navajo County PARCEL No. 304-11-045** for potential water rights.

This order opens a case to determine rights to use water on the parcel listed above. Apache Railway Company filed both the statement of claimant (“SOC”), 39-83032, and

1 the basis of the potential water right, 36-15020, in this case. However, the Navajo County
2 Assessor has identified **Gateway Oasis IV LLC** as the owner of the subject parcel.
3 Claimants and current landowners who intend to pursue water rights claims associated
4 with this property must attend the initial status conference scheduled for **June 11, 2026,**
5 **at 10:30 am.**

6 Interested parties MUST attend the scheduled initial conference if they plan to
7 pursue potential water rights. Failure to appear at the initial conference could result in the
8 dismissal of this case and the loss of water rights associated with the property. The
9 conference will be held virtually using the Court Connect program. Instructions for Court
10 Connect are attached as Attachment A.

11 **SUMMARY OF CASE**

12 Arizona Department of Water Resources (“ADWR”) records indicate that The
13 Apache Railway Company filed SOC 39-83032 in 1984, claiming water for stock watering
14 uses dating to 1886. The filing of a statement of claimant declares an individual’s intent
15 to claim a water right and begins the process of pursuing that water right with the Court.

16 ADWR investigated the claimed water use and issued watershed file report no.
17 33-51-031 in 1991. After the watershed file report was issued, the public was allowed an
18 opportunity to object to the findings in the report if they believed that there were errors.
19 The only objection filed was submitted by Apache Railway Company, disputing
20 ownership and point of use. Copies of objection in this case can be found under the
21 relevant case name and number on the following website:

22 <http://www.superiorcourt.maricopa.gov/SuperiorCourt/GeneralStreamAdjudication/whatsNew.asp>
23

24 The Court recognizes that there has been a long delay between the filing of the
25 initial documents and the initiation of this case. Because of this delay, the property may
26 have changed ownership or may have been subdivided. Nonetheless, current landowners
27 may still obtain water rights. This case will determine water rights existing on the property
28 associated with the relevant watershed file report and resolve the objections to the

1 watershed file report.

2

3 **ATTACHMENTS TO THIS ORDER:**

4 Attachment A: Instructions on how to appear virtually or telephonically at the **June**
5 **11, 2026** initial conference.

6 Attachment B: Copy of WFR no. 33-51-031.

7 Attachment C: ADWR map showing land investigated in WFR no. 33-51-031.

8 Attachment D: Map showing the relevant tax parcels and current ownership.

9 Attachment E: Initial Court Approved Mailing List

10

11 **IT IS ORDERED** initiating contested case **CV 6417-33-5711**, *In re Melvin G. and*
12 *Ruth A. Riddlebarger* and scheduling an initial conference for **June 11, 2026, at 10:30**
13 **am.**

14 The initial Court Approved Mailing List for this case shall include all parties listed on
15 Attachment E to this order. Any document filed in this case must be served on all parties
16 listed on the Court Approved Mailing List. The list may be modified only by court order.

17 Anyone who would like to receive courtesy copies of minute entries and orders may
18 request inclusion on an email list by sending a request to:

19 **emily.natale@jbazmc.maricopa.gov**

20 If parties have questions regarding this order or any of the attachments, please
21 contact the Office of the Special Water Master at (602) 372-4115. Please note that staff
22 can only answer administrative questions and cannot provide legal advice.

23

24 Signed this 7th day of April 2026.

25

26

27

28

Sherril Zendri
Special Water Master

1
2
3
4
5
6
7
8
9
10
11
12
13
14
15
16
17
18
19
20
21
22
23
24
25
26
27
28

On April 7, 2026, the original of the foregoing was delivered to the Clerk of the Apache County Superior Court for filing and distributing a copy to all persons listed on the Court-approved mailing list for this contested case, a copy of which is attached, and to all persons listed on the Court-approved mailing list for CV 6417.



Emily Natale

1
2
3
4
5
6
7
8
9
10
11
12
13
14
15
16
17
18
19
20
21
22
23
24
25
26
27
28

ATTACHMENT A



Court Connect Hearing Notice for In re Melvin G. and Ruth A. Riddlebarger

This hearing will be conducted through the new Court Connect program offered by the Superior Court of Arizona in Maricopa County. This new and innovative program allows Court participants to appear online, rather than in a physical courtroom. Hearings are preferably conducted by videoconference but can also be conducted by phone. Lawyers (and self-representing litigants) are responsible for distributing this notice to anyone who will be appearing on their behalf.

All participants must use the JOIN COURT CONNECT HEARING button or the dial in information below to participate.

Participants: Please follow the steps below to participate in the remote proceeding.

1. Click the JOIN COURT CONNECT HEARING button below.
2. Enter your full name and role in name field.
3. Wait for the facilitator to admit you to the proceeding.

Remember to keep this email handy so you can use it to participate in the following proceeding.

Case Name: In re Melvin G. and Ruth A. Riddlebarger

Contested Case No. CV 6417-33-5711

Start Date/Time: June 11, 2026, at 10:30 am.

JOIN COURT CONNECT HEARING

Dial-in Information: +1 917-781-4590

Private Dial-in Information: for privacy purposes, you can block your phone number by dialing *67 +1 917-781-4590

Dial-in Access Code: 688 970 203#

Tiny URL: <https://tinyurl.com/specialwatermaster>

1
2
3
4
5
6
7
8
9
10
11
12
13
14
15
16
17
18
19
20
21
22
23
24
25
26
27
28

ATTACHMENT B
Watershed File Report

LAND OWNER _____ WATERSHED FILE NO. _____
 RIDDLEBARGER, MELVIN G. O33-51-031
 & RUTH A.

A P P L I C A B L E F I L I N G S A N D D E C R E E S

CLEARLY STATED INFORMATION FROM FILINGS AND DECREES

FILING NUMBER	FILING STATUS	USES	QUANTITY IN AFA	USE LOCATION SECTION	TWNP	RNGE	CLAIM DATE	DIVERSION SECTION	LOCATION TWNP	RNGE
36-0015026		STOCKWATERING	.25				1886	NWSW10	11ON	22OE
39-0083032		STOCKWATERING	.25	NENWSW10	11ON	22OE	1886	NENWSW10	11ON	22OE

D W R A N A L Y S I S O F F I L I N G S A N D D E C R E E S

FILING NUMBER	USES CLAIMED OR REFERENCED	USES FOUND BY DWR	APPLIES TO DIVERSIONS	APPLIES TO PWR NUMBERS
36-0015026	STOCKWATERING	STOCKWATERING		SWOO1
39-0083032	STOCKWATERING	STOCKWATERING		SWOO1

U S E S

PWR #	LOCATION SECTION	TWNP	RNGE	SUPPLIED BY DIVERSIONS	WATER SOURCE	PHOTO DATE	SOURCE CHANGE	FACILITY NAME
SWOO1	SENWSW10	11ON	22OE		SURFACE		NO	INSTREAM USE

P W R S U M M A R Y

PWR #	APPLICABLE ADJ FILINGS	APPLICABLE PRE FILINGS	** APPARENT FIRST USE DATE	** DATA SOURCE	DRAINAGE AREA/ WATER SOURCE NAME
SWOO1	39-0083032	36-0015026	1886	36-0015026	SILVER CREEK

Q U A N T I T I E S O F U S E

PWR #	QUANTIFICATION TYPE	APPLICABLE ACREAGE/SURFACE AREA (ACRES)	WATER DUTY	ESTIMATED VOLUME	REMARKS
SWOO1					SEE VOLUME 1

E X P L A N A T I O N

FILINGS AND DECREES
 FILINGS 36-15020 & 39-83032 WERE FILED BY THE APACHE RAILWAY COMPANY.

USES AND RESERVOIRS
 SW1 - INSTREAM STOCKWATERING USE FROM SILVER CREEK.

ATTACHMENT D

Assessor Map Parcels

- 1
- 2
- 3
- 4
- 5
- 6
- 7
- 8
- 9
- 10
- 11
- 12
- 13
- 14
- 15
- 16
- 17
- 18
- 19
- 20
- 21
- 22
- 23
- 24
- 25
- 26
- 27
- 28

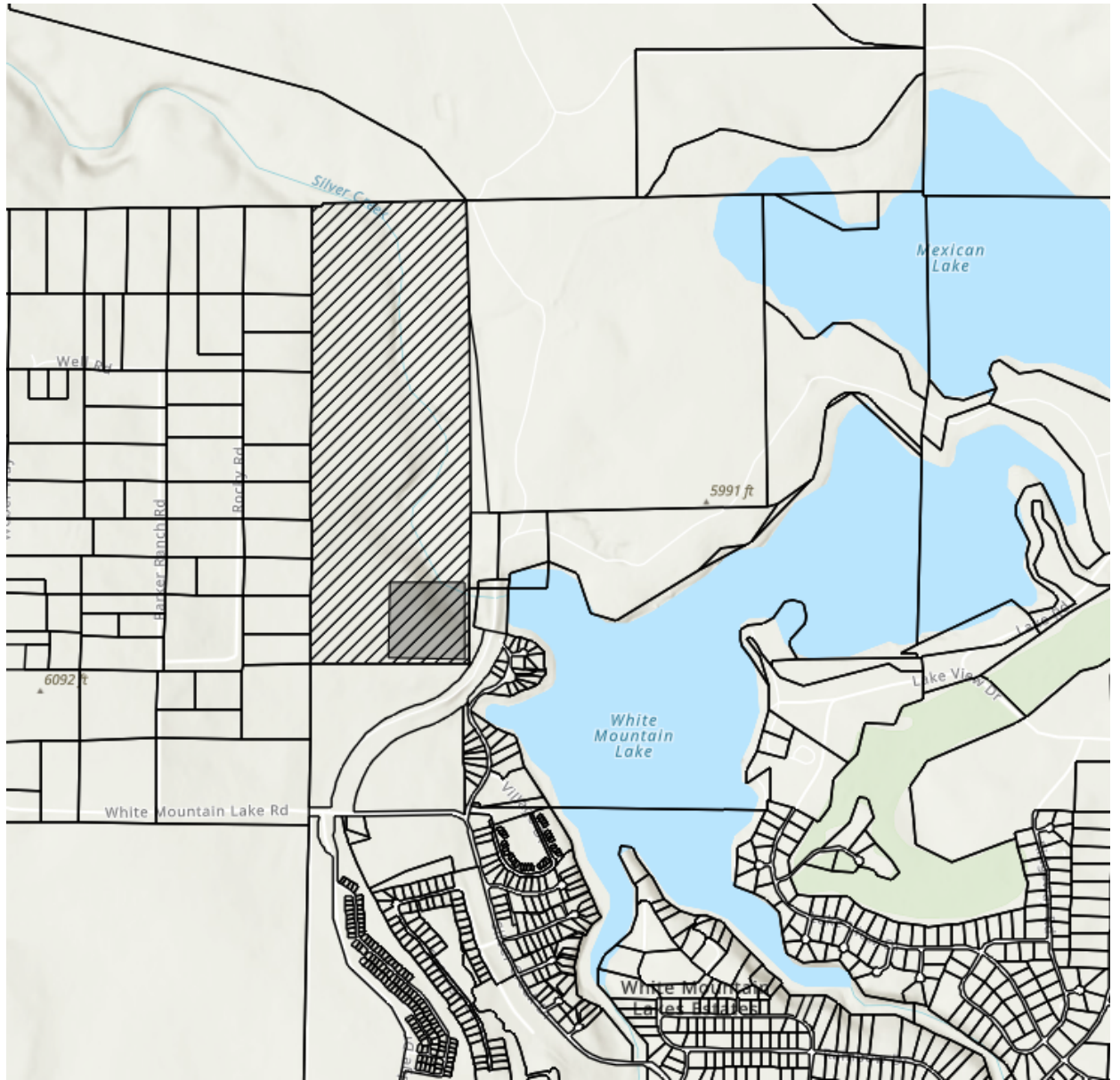

ATTACHMENT E

Initial Court-Approved Mailing List

1
2
3
4
5
6
7
8
9
10
11
12
13
14
15
16
17
18
19
20
21
22
23
24
25
26
27
28

Arizona Department of Water Resources
Kimberly R. Parks and Karen J. Nielsen
1110 West Washington, Suite 310
Phoenix, AZ 85007

Gateway Oasis IV LLC
c/o Brad Woodruff
10025 E. Dynamite Rd. Suite E140
Scottsdale, AZ 85262

The Apache Railway Company
c/o James E. Brophy
3200 N. Central Ave. Suite 1600
Phoenix, AZ 85012

Clerk of the Superior Court
Apache County
P.O. Box 365
St. Johns, AZ 85936

Special Master Sherri Zendri
Superior Court of Arizona
201 W. Jefferson Street
Courtroom 301
Phoenix, AZ 85003