

1
2
3
4
5
6 **ARIZONA GENERAL STREAM ADJUDICATION**
7 **IN THE SUPERIOR COURT OF THE STATE OF ARIZONA**
8 **IN AND FOR THE COUNTY OF MARICOPA**

9 IN RE THE GENERAL
10 ADJUDICATION OF ALL RIGHTS
11 TO USE WATER IN THE GILA
12 RIVER SYSTEM AND SOURCE

W-1, W-2, W-3, W-4 (Consolidated)

Contested Case No. **W1-11-1896**

11 **ORDER INITIATING CONTESTED**
12 **CASE AND SCHEDULING INITIAL**
13 **CONFERENCE HEARING**

14 **CONTESTED CASE NAME:** *In re Sandra B. and Charles E. Beeler*

15 **HSR INVOLVED:** San Pedro Hydrographic Survey.

16 **DESCRIPTIVE SUMMARY:** The Clerk of Maricopa County Superior Court is directed
17 to initiate W1-11-1896. Parties who wish to pursue this case are ordered to attend an initial
conference hearing scheduled for **Tuesday, January 7, 2025, at 11:00 am**

18 **NUMBER OF PAGES:** 14

19 **This order opens a case to determine legal rights to use water.**

20 **This case is NOT being initiated because of any improper water use.**

21 **Failure to participate may result in dismissal of potential water rights.**

22
23 The state of Arizona is currently undergoing a General Stream Adjudication to
24 determine water use and create an accurate, enforceable record of those rights. In Arizona,
25 surface water, and water pumped from some wells,¹ belongs to the general public. An
26 enforceable right to use this “appropriable” water may be acquired after review and
27

28 ¹ Arizona law includes wells that may be pumping surface water in the General Stream Adjudication and subject to all requirements for surface well use.

1 approval by Arizona’s General Stream Adjudication Court. This Court has been
2 instructed to evaluate claims to use water in much of the state of Arizona and determine
3 the date of first use, amount, and type of potential water use. This process, the “general
4 stream adjudication,” is currently evaluating **COCHISE COUNTY PARCEL No. 208-**
5 **61-008A** for potential water rights to be included in the catalog of water rights for the Gila
6 River system.

7 This court order opens a case to determine rights to use water on the parcel listed
8 above, that the Cochise County Assessor has identified as owned by **SONIA G. AND**
9 **RAYMOND A. PRECIADO**. Current landowners who intend to pursue any potential
10 water rights associated with this case must attend the initial status conference scheduled
11 for **Tuesday, January 7, 2025, at 11:00 am**. Interested Parties **MUST** attend the
12 scheduled initial conference if they plan to pursue potential water rights. Failure to appear
13 at the initial conference could result in the dismissal of the case and the loss of water rights
14 associated with the property. The conference will be held virtually using the Court
15 Connect program. Instructions for Court Connect are attached as Attachment A.

16 17 **CURRENT LANDOWNERS**

18 **SONIA G. AND RAYMOND A. PRECIADO** are the current landowners of
19 **COCHISE COUNTY PARCEL No. 208-61-008A**, which was previously owned by
20 Charles E. and Sandra B. Wheeler.

21 Arizona Department of Water Resources (“ADWR”) records indicate that Charles
22 E. and Sandra B. Beeler filed Statements of Claimant 39-5815 in June 1980, claiming
23 water for irrigation, domestic use, and stock and wildlife watering dating to April 1935.
24 The filing of a Statement of Claimant declares an individual’s intent to claim a water right
25 and begins the process of pursuing that water right with the Court.

26 ADWR investigated this potential water use and issued Watershed File Report No.
27 112-17-BAB-008. After the Watershed File Report was issued, the public was allowed an
28 opportunity to object to the findings in the report if they believed there were errors or

insufficient documentation. This case will determine water rights existing on the property associated with the relevant Watershed File Report and resolve the objections to the Watershed File Report.

The Court recognizes there has been a long delay between the filing of the initial documents and the initiation of this case. Because of this delay, the property has changed ownership and may have been subdivided. Nonetheless, current landowners may still obtain water rights. Below is a summary of the water use found on the property at the time of the Report:

Watershed File Report - #112-17-BAB-008			
Statement of Claimant #	39-5815		
Claimant Name	Charles E. and Sandra B. Beeler		
Cochise Co. Tax Parcel	208-61-008A		
Existing Claims	25 acre-feet annually for irrigation	4 acre-feet annually for domestic use	0.5 acre-feet annually for stock watering and wildlife
Water use found during ADWR investigation	31.2–41.6 acre-feet annually	Not reported	None
Basis of Right	None	None	None

ADWR public records do not contain any assignments of the Statements of Claimant listed in the Watershed File Report nor do the current landowners appear to have filed any additional Statements of Claimant since the issuance of the HSR. Arizona law requires that for parties to obtain a legal water right, they must provide proof of their right by presenting to the Court an updated and accurate Statement of Claimant claiming a water right paired with the appropriate basis of right, e.g. a statement of claim, decree, stockpond registration, or water rights certificate. According to the Watershed File Report, the following information will be needed to acquire a water right on this property:

- A. Earliest evidence of water use on the property.
- B. An accurate Statement of Claimant in the name of the current landowner. The current landowner may fulfill this requirement by either filing a new statement of claimant or obtaining an assignment or amendment of a preexisting statement

of claimant.

C. A basis of right in the name of the current landowner (unless the basis is a prior judicial decree) and accurately describing the claimed use. The current landowner may fulfill this requirement by either filing a new basis of right or obtaining an assignment or amendment of a preexisting basis of right.

If the property owner is able to provide this proof to the Court to show the existence of a water right on their property, the court can recognize an enforceable water right in a “Final Decree.” Ariz. Rev. Stat. § 45-257(B). Alternatively, landowners may enter into Court approved settlements with the objecting parties.

OBJECTING PARTIES

Objectors to a potential water right must present the Court with a specific statement objecting to a specific potential water right attribute. Ariz. Rev. Stat. § 45-256(B). Where an objection does not meet this requirement, the objecting party shall provide a detailed explanation of their objection during the initial conference hearing. The following have filed objections in this contested case:

Objector(s)	Summary of Objections
Salt River Project	<ul style="list-style-type: none">ADWR’s “maximum observed” and “regional” methods for estimating irrigation water use should be rejected entirely. The “maximum potential” method should be corrected.ADWR failed to include a water use rate.
Gila River Indian Community, San Carlos Apache Tribe, Yavapai-Apache Nation (collectively “the Tribes”)	<ul style="list-style-type: none">The water used is subject to federal and Indian claimsThe WFR does not show a well registration filing.ADWR failed to include a water use rate.
United States, joined by the Tribes	<ul style="list-style-type: none">The WFR does not show a basis of right.The water used is subject to federal and Indian claimsThe point of diversion is inconsistent with the Statement of Claimant.

	<ul style="list-style-type: none"> ADWR’s “maximum observed” and “regional” methods for estimating irrigation water use should be rejected.
Magma Copper Co. (currently BHP Copper) and ASARCO Inc.	<ul style="list-style-type: none"> The objectors assert that groundwater is not subject to the Adjudication. To the extent that groundwater use is subject to the Adjudication, ASARCO and Magma objected to use of water without an appropriative right or use in conflict with their rights.

Copies of objections in this case can be found under the respective case name and number on the following website:

<http://www.superiorcourt.maricopa.gov/SuperiorCourt/GeneralStreamAdjudication/whatsNew.asp>

ATTACHMENTS TO THIS ORDER:

Attachment A: Instructions on how to appear virtually or telephonically at the **Tuesday, January 7, 2025, at 11:00 am** initial conference.

Attachment B: Additional information and resources on the process for determining water rights in Arizona

Attachment C: Copy of WFR No. 112-17-BAB-008.

Attachment D: ADWR map showing land investigated in WFR No. 112-17-BAB-008.

Attachment E: Map showing the relevant tax parcels and current ownership.

Attachment F: Initial Court Approved Mailing List

IT IS ORDERED initiating contested case W1-11-1896, In re Sandra B. and Charles E. Beeler and scheduling an initial conference hearing for **Tuesday, January 7, 2025, at 11:00 am**. The initial Court-approved mailing list for this case shall include all parties listed on Attachment E to this order. Any document filed in this case must be served on all parties listed on the Court-Approved Mailing List. The list may be modified only by Court order. Anyone who would like to receive courtesy copies of minute entries and

1 orders may request inclusion on an email list by sending a request to:

2 *emily.natale@jbazmc.maricopa.gov.*

3 If parties have questions regarding this Order or any of the attachments, please
4 contact the General Stream Adjudication, Office of the Special Water Master, at (602)
5 372-4115. Please note that staff can only answer administrative questions and cannot
6 provide legal advice.

7 Signed this 21st day of November 2024.

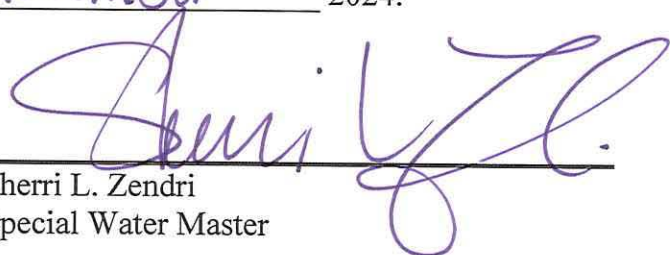
8
9
10
11 
12 Sherri L. Zendri
13 Special Water Master
14
15

16 On November 21, 2024 the original of
17 the foregoing was delivered to the Clerk of the
18 Maricopa County Superior Court for filing and
19 distributing a copy to all persons listed on the
20 Court-approved mailing list for this contested
21 case, a copy of which is attached, and to all persons
22 listed on the Court-approved mailing list for W1,
23 W2, W3, and W4.

24
25
26
27
28

Emily Natale

ATTACHMENT A



Court Connect Hearing Notice for In re Charles E. and Sandra B. Beeler

This hearing will be conducted through the new Court Connect program offered by the Superior Court of Arizona in Maricopa County. This new and innovative program allows Court participants to appear online, rather than in a physical courtroom. Hearings are preferably conducted by videoconference but can also be conducted by phone. Lawyers (and self-representing litigants) are responsible for distributing this notice to anyone who will be appearing on their behalf.

All participants must use the JOIN COURT CONNECT HEARING button or the dial in information below to participate.

Participants: Please follow the steps below to participate in the remote proceeding.

1. Click the JOIN COURT CONNECT HEARING button below.
2. Enter your full name and role in name field.
3. Wait for the facilitator to admit you to the proceeding.

Remember to keep this email handy so you can use it to participate in the following proceeding.

Case Name: In re Charles E. and Sandra B. Beeler

Contested Case No. W1-11-1896

Start Date/Time: Tuesday, January 7, 2025, at 11:00 am

JOIN COURT CONNECT HEARING

Dial-in Information: +1 917-781-4590

Private Dial-in Information: for privacy purposes, you can block your phone number by dialing *67 +1 917-781-4590

Dial-in Access Code: 688 970 203#

Tiny URL: <https://tinyurl.com/specialwatermaster>

To ensure an optimal experience, please review the brief Court Connect training prior to the hearing: [Here](#)

ATTACHMENT B

General Background on the Water Rights Determination Process in Arizona

A general stream adjudication is a judicial proceeding to determine the quantity and priority of all water rights in a river system. Arizona is undertaking general stream adjudications of both the Gila River and the Little Colorado River systems. A river system includes surface water flowing “in streams or other natural channels,” groundwater sufficiently connected to that surface water, and water (both surface and groundwater) subject to claims by the federal government. Ariz. Rev. Stat. § 45-251(7). Recognizing and respecting water rights and the priority of such rights is important in Arizona where times of drought or water scarcity can occur.

All cases begin with the filing of a “Statement of Claimant,” (“SOC”) in which a property owner makes a claim for a right to use surface water on their property. Ariz. Rev. Stat. § 45-254(A). This person is the “claimant.” The SOC contains, among other characteristics, a description of the source and quantity of the water used, the location of use, the location from which the water was diverted, and the date when the water was first put to use. *Id.* § 45-254(C).

After the property owner files the SOC, the Arizona Department of Water Resources (“ADWR”) prepares a “Watershed File Report,” (“WFR”) in which ADWR investigates the claims in the SOC and recommends water rights associated with the property. *Id.* § 45-256(B). ADWR compiles all WFRs for a watershed into a comprehensive Hydrographic Survey Report (“HSR”) and publishes the report for public review and comment. In response, other claimants in the Adjudication may file “objections” disputing the information or recommendations in the WFR. The individuals who file objections are called “objectors.”

This “contested case”, one of thousands in the Gila River System, will evaluate claims asserted in specific Statements of Claimant while considering objections to the WFR that reported ADWR’s initial inspection of those claims.

1
2
3
4
5
6
7
8
9
10
11
12
13
14
15
16
17
18
19
20
21
22
23
24
25
26
27
28

ATTACHMENT C
Watershed File Report

LAND OWNER	WATERSHED FILE
-----	REPORT NUMBER
-----	-----
BEELER, CHARLES E.	112-17-BAB-008
& SANDRA B.	

A P P L I C A B L E F I L I N G S A N D D E C R E E S

CLEARLY STATED INFORMATION FROM FILINGS AND DECREES

FILING NUMBER	FILING STATUS	USES	QUANTITY IN AFA	USE LOCATION SECTION	TWNP	RNGE	CLAIM DATE	DIVERSION LOCATION SECTION	TWNP	RNGE
39-0005815		IRRIGATION	25.00	NESE28	16OS	200E	1935	SWNESE28	16OS	200E
		DOMESTIC	4.00							
		STOCK	.50							
		REC/FISH/WLDF	.50							

D W R A N A L Y S I S O F F I L I N G S A N D D E C R E E S

FILING NUMBER	USES CLAIMED OR REFERENCED	USES FOUND BY DWR	APPLIES TO DIVERSIONS	APPLIES TO PWR NUMBERS
39-0005815	IRRIGATION	IRRIGATION	WO1	DM001, IRO01
	DOMESTIC	DOMESTIC		
	STOCK	INCIDENTAL		
	WILDLIFE	INCIDENTAL		

D I V E R S I O N S

DIV #	LOCATION SECTION	TWNP	RNGE	DIVERSION NAME	WATER SOURCE AND CLASSIFICATION
WO1	SWNESE28	16OS	200E	UNNAMED	GROUNDWATER : ZONE 1 OF THE SAN PEDRO RIVER

U S E S

PWR #	LOCATION SECTION	TWNP	RNGE	SUPPLIED BY DIVERSIONS	WATER SOURCES	PHOTO SOURCE DATE	SOURCE CHANGE	FACILITY NAME
DM001	SWNESE28	16OS	200E	WO1	GROUNDWATER : ZONE 1		NO	
IRO01	NESE28	16OS	200E	WO1	GROUNDWATER : ZONE 1	1979	NO	

P W R S U M M A R Y

PWR #	APPLICABLE ADJ FILINGS	APPLICABLE PRE FILINGS	*APPARENT FIRST USE DATE*	DATE BASIS FOR DATE	WATER SOURCES AND CLASSIFICATIONS
DM001	39-0005815	NONE			GROUNDWATER : ZONE 1 OF THE SAN PEDRO RIVER
IRO01	39-0005815	NONE	1979 1979	AERIAL PHOTO	GROUNDWATER : ZONE 1 OF THE SAN PEDRO RIVER

Q U A N T I T I E S O F U S E

PWR #	QUANTIFICATION TYPE	ACRES	CROP TYPE	EFF	WATER DUTY	ESTIMATED VOLUME	REMARKS
DM001							SEE VOLUME 1 - GENERAL ASSESSMENT
IRO01	MAX. OBSERVED	4.0	TURF	32%	7.8 AF/AC	31.2 AFA	
	REGIONAL	4.0	AVE. CROP	50%	5.4 AF/AC	21.6 AFA	
	MAX. POTENTIAL	4.0	ALFALFA	32%	10.4 AF/AC	41.6 AFA	

E X P L A N A T I O N

DIVERSIONS

W1 - WELL PROVIDES WATER FOR IRRIGATION, DOMESTIC, STOCKWATERING, AND WILDLIFE USES.

USES AND RESERVOIRS
DM1 - DOMESTIC USE.

FILE 112-17-BAB-008 (CONTINUED)
E X P L A N A T I O N (CONTINUED)

CONTINUATION OF PAGE: 24

IR1 - IRRIGATED TURF AND GRASS.

DISPOSITION OF LAND OWNER/CLAIMANT COMMENTS

A COMMENT WAS RECEIVED FROM THE LAND OWNER WHICH VERIFIED LAND OWNERSHIP.

ATTACHMENT D

ADWR Map of Area Investigated [denoted as “(8)”]

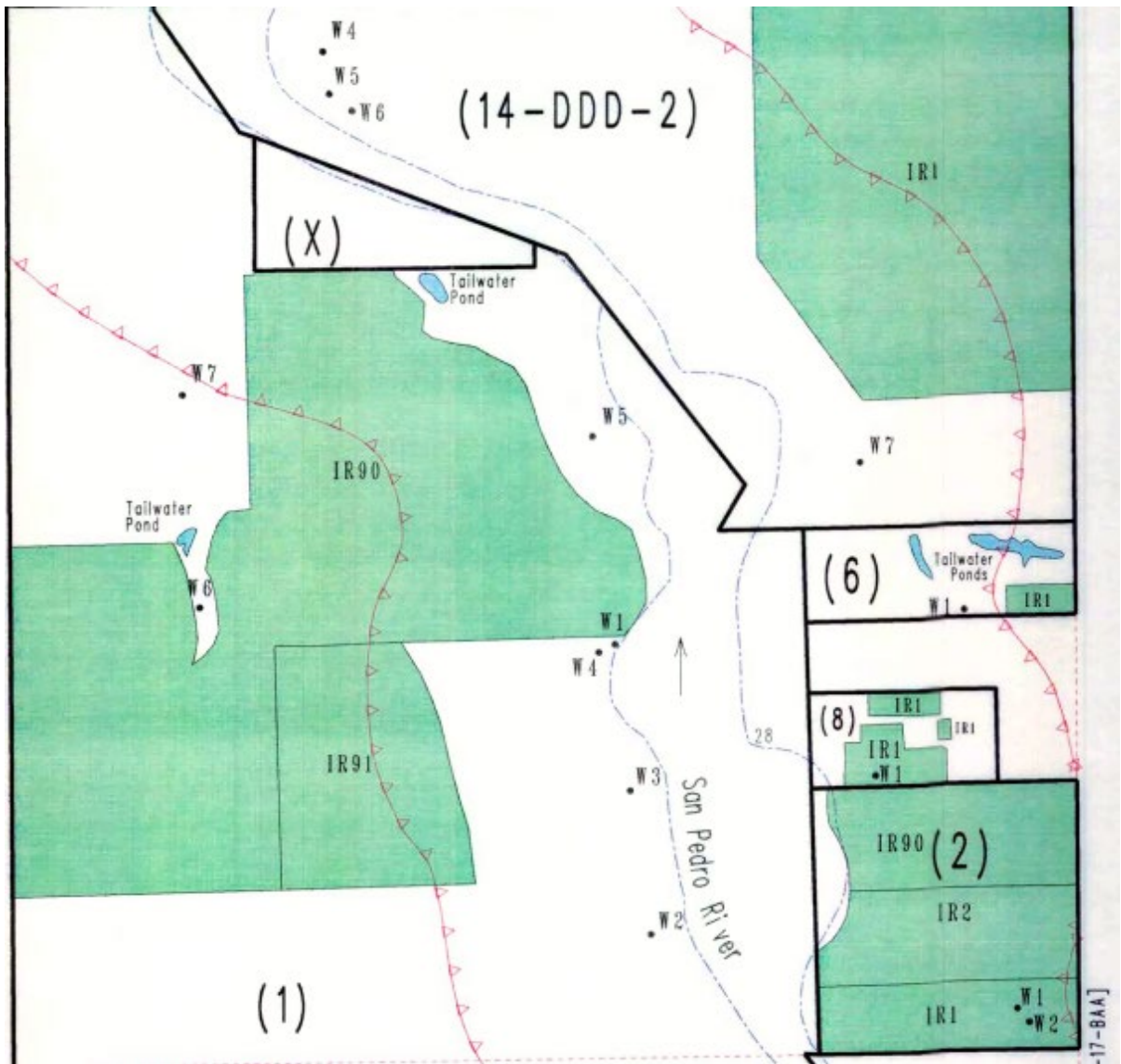

1
2
3
4
5
6
7
8
9
10
11
12
13
14
15
16
17
18
19
20
21
22
23
24
25
26
27
28

ATTACHMENT E
Cochise County Assessor Map

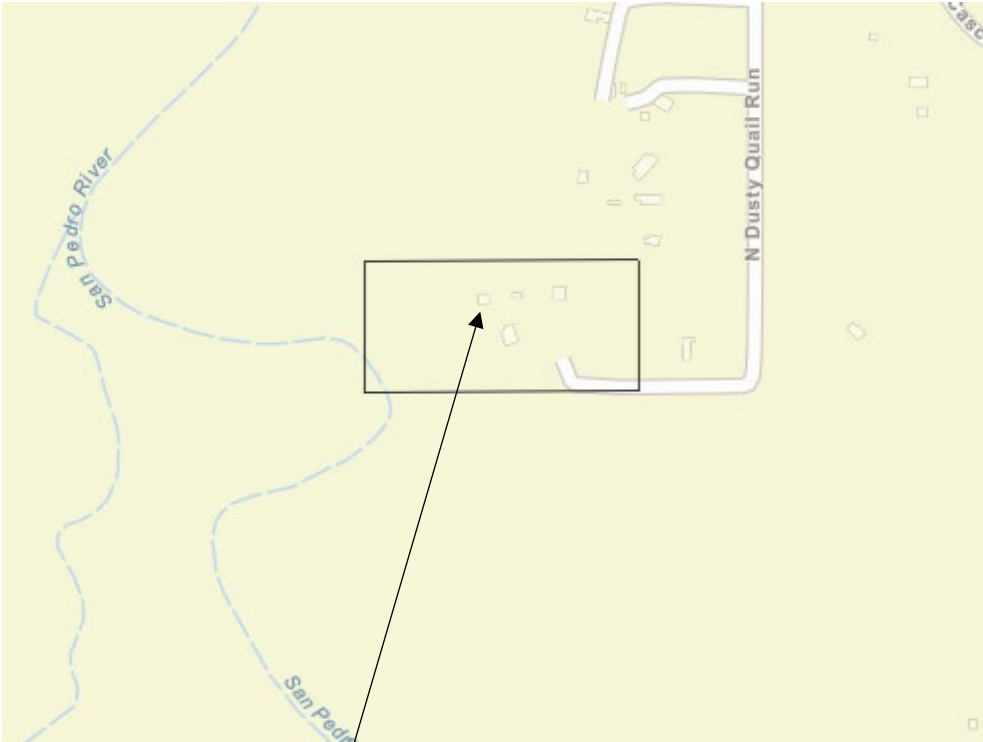

APN:208-61-008A
Sonia G. and Raymond A. Preciado

ATTACHMENT F

Initial Court-Approved Mailing List

Arizona Department of Water Resources
Kimberly R. Parks and Karen J. Nielsen
1110 West Washington, Suite 310
Phoenix, AZ 85007

Susan B. Montgomery, Robyn Interpreter,
Montgomery & Interpreter PLC
3301 E Thunderbird Road
Phoenix, AZ 85032

Clerk of the Superior Court
Maricopa County
Attn: Water Case
601 West Jackson St.
Phoenix, AZ 85003

Gila River Indian Community
Javier Ramos and Michael Carter
Office of the General Counsel
P.O. Box 97
Sacaton, AZ 85147

Special Master Sherri Zendri
Superior Court of Arizona
201 W. Jefferson Street
Courtroom 301
Phoenix, AZ 85003

Merrill C. Godfrey and Brette A. Pena
Akin Gump Straus Hauer & Feld LLP
2001 K Street, N.W.
Washington, DC 20006

Alexander B. Ritchie
San Carlos Apache Tribe
Office of the Attorney General
PO Box 40
San Carlos, AZ 85550

J. B. Weldon, M. A. McGinnis, M. K. Foy
Salmon, Lewis & Weldon
2850 E. Camelback Rd. Suite 200 Phoenix,
AZ 85016

Laura Boyer & Maggie Woodward
United States Dept. of Justice – ENRD
P.O. Box 7611, Ben Franklin Station
Washington, DC 20044

Lauren Caster
Fennemore Craig, P.C.
2394 East Camelback Road Ste 600
Phoenix, AZ 85016-3429

Joe P. Sparks and Laurel A. Hermann
The Sparks Law Firm, P.C.
7503 First Street
Scottsdale, AZ 85251-4573

John D. Burnside
Snell & Wilmer, L. L. P.
One E. Washington Street, Suite 2700
Phoenix, AZ 85004-2556

Jeremiah Weiner, Brett J. Stavin, and
Jay Lee
Rosette, LLP.
120 S. Ash Avenue, Suite 201
Tempe, AZ 85281

Sonia G. and Raymond A. Preciado
1578 N. Dusty Quail Run
Benson, AZ 85602-8005

Charles E. and Sandra B. Beeler
P.O. Box 250
St. David, AZ 85630